

TO OPEN

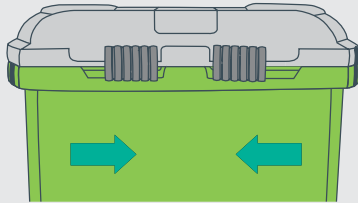

Slide both front locks towards centre.

USAGE

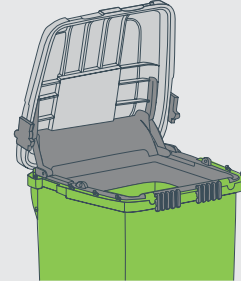

Open lid fully in order to deposit single-use metal instruments. When used in conjunction with foot pedal accessory, step on foot pedal to open collectors.

IN USE

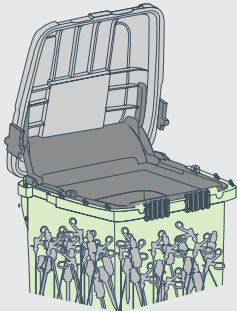

Fill with single-use metal instruments only. Once full, the collector must be permanently locked and replaced.

CLOSE

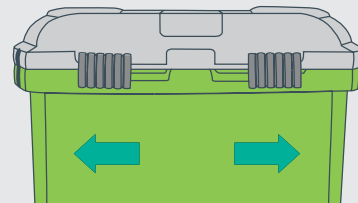

Slide both front locks away from each other.

LOCK

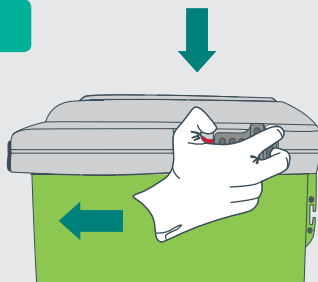

1 Depress red tab and slide both side catches completely forward.

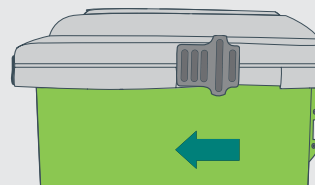

PLEASE NOTE
Side locks are permanent!

2 Both side locks must be engaged in a fully forward position.

Remember

- Never put hands into the collector.
- Always close collector before moving/removing collector.
- Do not deface or write on collector.
- Always dispose of sharps and sharps safety devices into sharps collectors.